

Aluminum Frame Markerboard

Egan Markerboards feature EVS™ surface or EganBoard Porcelain framed in clear anodized aluminum frame with either eased-curve or precision square mitered corners. Guaranteed-to-clean and never warp, Egan Aluminum Frame Markerboards are magnet-compatible, and are designed to complement curved or square corner frame Tackboards (MDTB), sold separately.

When specifying, it is important to notice that EVS and EganBoard Porcelain are designed with slightly different shades of white. When installed side-by-side, the difference in hue is noticeable. See the Egan Color and Finish Guide for details. Aluminum frame markerboards in square corner only are also available with a Full Length Integrated Aluminum Marker Tray (MFTE/MFTM).

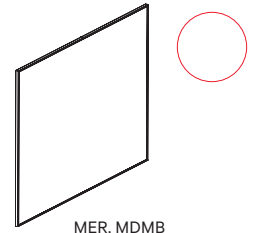

MER, MDMB

Aluminum Frame Markerboard - EVS (MER, MES)



Curved Frame	Square Frame	Dimensions	Price	EganINK ¹	Full Length Plastic Marker Tray (Y)
MER2436	MES2436	24" w x 36" h	\$380	\$90	\$21
MER4832	MES4832	48" w x 32" h	\$510	\$160	\$40
MER4836	MES4836	48" w x 36" h	\$580	\$180	\$40
MER4848	MES4848	48" w x 48" h	\$690	\$240	\$40
MER6048	MES6048	60" w x 48" h	\$810	\$300	\$50
MER7248	MES7248	72" w x 48" h	\$930	\$360	\$68
MER9648	MES9648	96" w x 48" h	\$1 090	\$480	\$80
	MES8553W⁺	85" w x 53" h	\$1 350	\$470	\$72
	MES12048W	120" w x 48" h	\$1 390	Inquire*	\$101

Standard 16" w x 1 5/8" d plastic marker tray included. Full Length Plastic Marker Tray (Y) is optional.
¹ Price per board. Minimum EganINK upcharge per order is \$150
⁺ Optimized for 16:10 projection aspect ratio
^{*} Call Customer Service

Aluminum Frame Markerboard - EganBoard Porcelain (MDMB, MDMS)

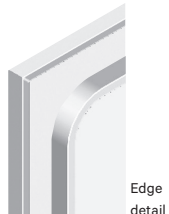

White Porcelain is available on Custom Response.

Curved Frame	Square Frame	Dimensions	Price	Full Length Plastic Marker Tray (Y)
MDMB2436	MDMS2436	24" w x 36" h	\$400	\$21
MDMB4832	MDMS4832	48" w x 32" h	\$550	\$40
MDMB4836	MDMS4836	48" w x 36" h	\$620	\$40
MDMB4848	MDMS4848	48" w x 48" h	\$740	\$40
MDMB6048	MDMS6048	60" w x 48" h	\$860	\$50
MDMB7248	MDMS7248	72" w x 48" h	\$1010	\$68
MDMB9648	MDMS9648	96" w x 48" h	\$1 220	\$80

Standard 16" w x 1 5/8" d plastic marker tray included. Full Length Plastic Marker Tray (Y) is optional. Porcelain surface is not EganINK compatible

Mount Options

Wall Mount Bracket: **W** Top Bracket: **T** System Mount: **S**

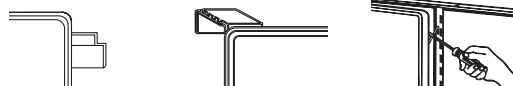

Top Mount brackets are universal and can be easily adjusted to accommodate any workstation panel measuring from 1 3/4" to 2 3/4" thick. Adjustable by 1/8" increments. Due to weight restraints 72" w x 48" h, 85" x 53", 96" w x 48" h and 120" x 48" boards are not available with Top Bracket or System Mount. Brackets are aluminum with a clear anodized finish. Custom colors are not available on the brackets. Plastic protective sleeves are included to assure no damage is caused to the system. For panels 2 3/4"-4" deep please specify EOEX at \$12.

How To Order:

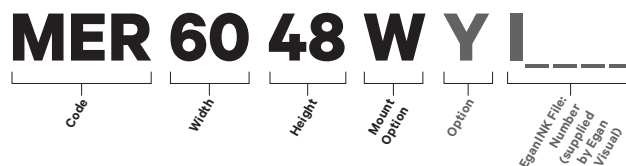

Custom Sizes:

Select next larger size and add \$60 list

Custom Color:

Set up, per color \$190
 Additional cost each item \$68

What's in the box:

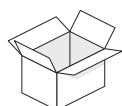

- Ships with mounting bracket as specified, one (1) marker tray, four (4) assorted color Dry-Erase markers and one (1) EganCloth



Product notes:



- Magnet compatible

Parcel Service items (📦) ship 'Freight Included'. Instant Ship products are identified by combining codes indicated in **RED**.