

VersaJOT

Designed for quick and easy installation, this amazing pressure sensitive adhesive, dry-erase product applies to most finished surfaces in seconds. VersaJOT is offered in units precisely cut to Customer's Own Art patterns (COA). VersaJOT pieces are custom-shape, precision CNC cut from a 54" wide roll on an 84" long bed, and are applied with high-adhesive glue. Volume pricing is available.

Specifying VersaJOT

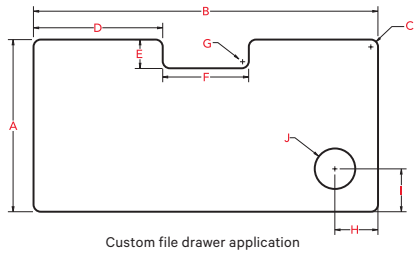

- A. Height
- B. Width
- C. Corner Radius**
- D. Notch Inset Horizontal
- E. Notch Inset Vertical
- F. Notch Width
- G. Notch Corner Radius**
- H. Knock-out Inset Horizontal
- I. Knock-out Inset Vertical
- J. Knock-out Diameter

VersaJOT is cut to your specifications for your custom requirement. Exact measurements are required.

** 1/4" radius corners are standard unless specified otherwise. Minimum radius corner is 1/8"

Customer's Own Art



Egan Visual is pleased to accept COA patterns prepared in suitable vector file formats: AutoCad (DWG or DXF), Adobe Illustrator (EPS or AI), Corel Draw (EPS or CDR) to Encapsulated Postscript (EPS). Egan Visual will execute designs exactly as provided. Suitable vector files contain mathematical shapes. Embedding or "copying-and-pasting" a raster image such as a BMP, PSD, JPG, GIF, or PNG into a vector file is not suitable and will be subject to engineering charges. All VersaJOT orders are customized. Egan Visual does not accept responsibility for errors in customer instructions. Submitting a purchase order with a suitable vector file for VersaJOT release Egan Visual from responsibility for specification errors discovered upon installation.

VersaJOT (VJ)

VersaJOT is cut from a 54"w roll and is offered on a linear foot basis. For an accurate quote, call Egan Customer Service.

LFT	Price/LFT	EganINK/LFT
7-49	\$109	\$177
50-99	\$99	\$167
100+	\$87	\$155

• 7 linear feet is the minimum order size

How To Order:

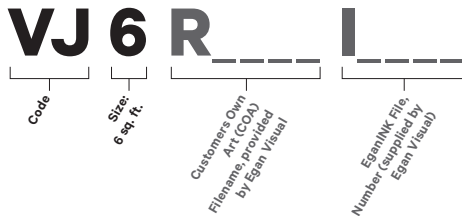

Installation Guidelines for VersaMAG and VersaJOT

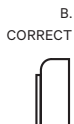

Edge Overhang: Measure VersaMAG/ VersaJOT to inset especially on rounded corners. Example "A" will cause VersaJOT to peel off. Example "B" is a good inset from the edge.

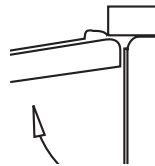

Clearance Required: Allow for clearance on moving surfaces. The hutch door in this example does not have enough clearance (1/16"), causing an obstruction at the hinge area.

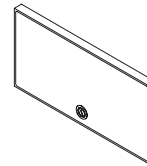

Specify VersaJOT with a 1/8" inset around edges and locks to ensure a good fit. VersaMAG is NOT available with notches or cut outs.

What's in the box:

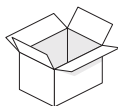

- Ships with two (2) assorted color Dry-Erase Markers and one (1) EganCloth. Contingent upon standard size cut sheets.

Product notes:

- One knock-out shape provided at no charge. Additional knock-outs, add \$145 per sized pattern. Upcharge applies once per drawing when number of knock-outs are 2 or more on that same drawing
- Engineering charges of \$145 minimum will be applied to orders with incorrect file format
- Maximum dimensions are 54" x 84". VersaJOT has a thickness of 0.050". Minimum corner radius 1/8". Egan guarantees +/- 1/16" accuracy overall
- Square footage to be taken from gross material requirement for final pattern
- A self adhesive compact marker tray kit (VJCC) is available
- Add 1" to both Width and Height when specifying EganINK square footage



Parcel Service items (📦) ship 'Freight Included'. Instant Ship products are identified by combining codes indicated in RED.