

**EGAN**

## **ALUMINUM FRAME**

MES (EVS), MDMS (Porcelain) & MDTS (Tack) MFTE (Integrated Full Length Tray with EVS) MFTM (Integrated Full Length Tray with Porcelain) SPEC SHEET





# PRODUCT SPECIFICATIONS & FEATURES

## FEATURES



GreenGuard Gold Certified



Professional Grade Surface



maharam Tackable Fabric

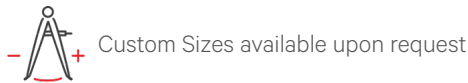

Custom Sizes available upon request

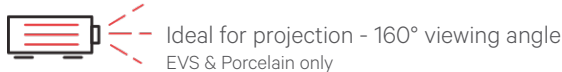

Ideal for projection - 160° viewing angle  
EVS & Porcelain only

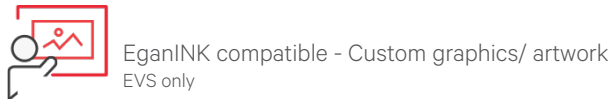

EganINK compatible - Custom graphics/ artwork  
EVS only



Magnet compatible  
EVS & Porcelain only

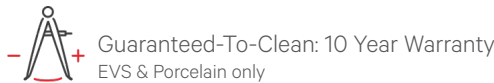

Guaranteed-To-Clean: 10 Year Warranty  
EVS & Porcelain only

## DIMENSIONS & WEIGHT

MES, MDMS, & MDTs

PRODUCT SIZE	PRODUCT WEIGHT (LBS)			SHIPPING SIZE	SHIPPING WEIGHT (LBS)		
	EVS	Porcelain	Tack		EVS	Porcelain	Tack
24”w x 36”h x 0.81”d	11	12	14	41.06”w x 29.06”h x 2.38”d	15	16	18
48”w x 36”h x 0.81”d	22	24	28	53.31”w x 41.06”h x 2.38”d	30	32	36
48”w x 48”h x 0.81”d	29	32	37	53.31”w x 53.31”h x 2.38”d	39	42	48
60”w x 48”h x 0.81”d	37	40	47	65.19”w x 53.31”h x 2.38”d	49	52	59
72”w x 48”h x 0.81”d	44	48	56	77.38”w x 53.31”h x 2.38”d	59	62	70
96”w x 48”h x 0.81”d	59	64	75	101.75”w x 53.31”h x 2.38”d	77	83	94
120”w x 48”h x 0.81”d	73	-	-	125.38”w x 53.31”h x 2.38”d	96	-	-

## PRODUCT PHOTOS

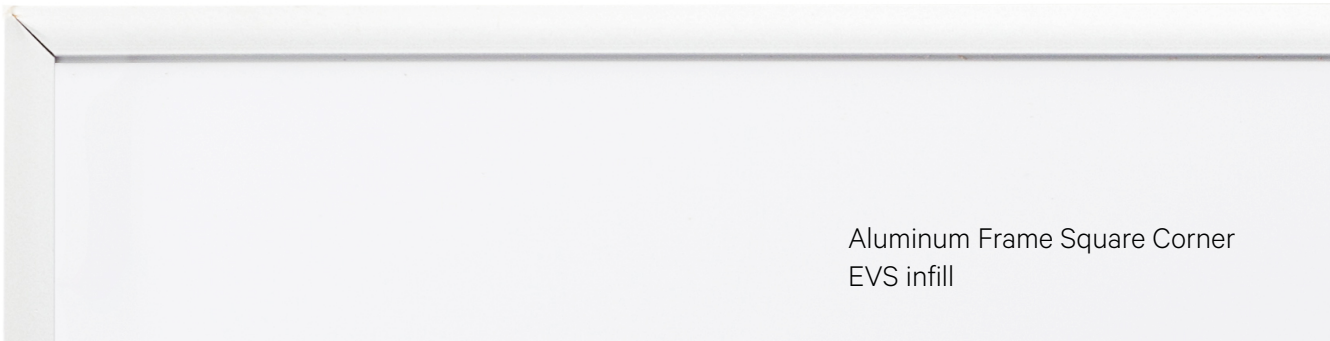

Aluminum Frame Square Corner  
EVS infill

## DIMENSIONS & WEIGHT

MFTE

PRODUCT SIZE	PRODUCT WEIGHT (LBS)	SHIPPING SIZE	SHIPPING WEIGHT (LBS)
	EVS		EVS
24”w x 36”h x 0.81”d	12	41.06”w x 29.06”h x 2.38”d	16
48”w x 36”h x 0.81”d	24	53.31”w x 41.06”h x 2.38”d	32
48”w x 48”h x 0.81”d	32	53.31”w x 53.31”h x 2.38”d	42
60”w x 48”h x 0.81”d	40	65.19”w x 53.31”h x 2.38”d	52
72”w x 48”h x 0.81”d	48	77.38”w x 53.31”h x 2.38”d	62
96”w x 48”h x 0.81”d	64	101.75”w x 53.31”h x 2.38”d	83

## PRODUCT PHOTOS



Aluminum Frame Markerboard with Integrated Full Length  
Tray | EVS infill



Linked Aluminum Frame Square Corner EVS infill, EganINK,  
& Tackable Fabric: Maharam, Manner, Aquatic



BOARD HEIGHT & WIDTH

48 x 48		60 x 48	72 x 48	96 x 48	120 x 48
24 x 36	48 x 36				

BROAD PROFILE & INSTALL

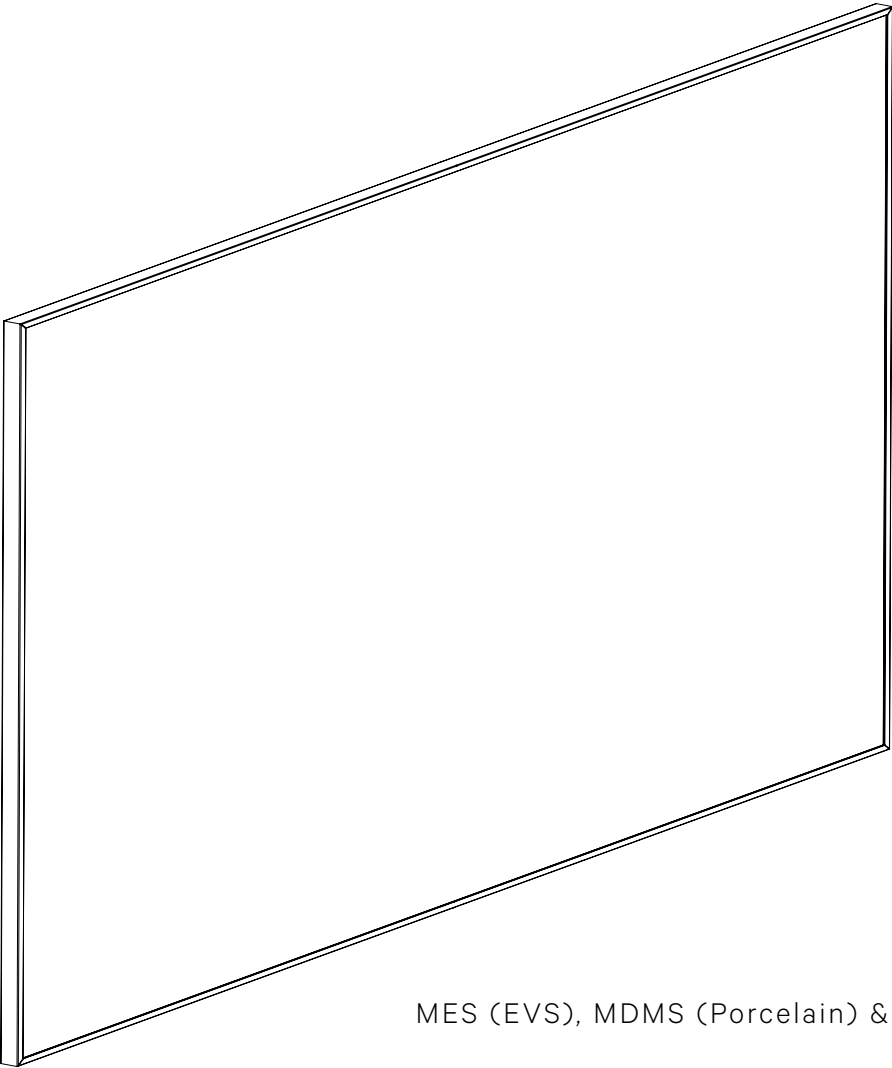

MES (EVS), MDMS (Porcelain) & MDTs (Tack)



Clear Anodized  
Aluminum Frame

EVS or Porcelain  
Surface

Honeycomb  
Core

Steel Back

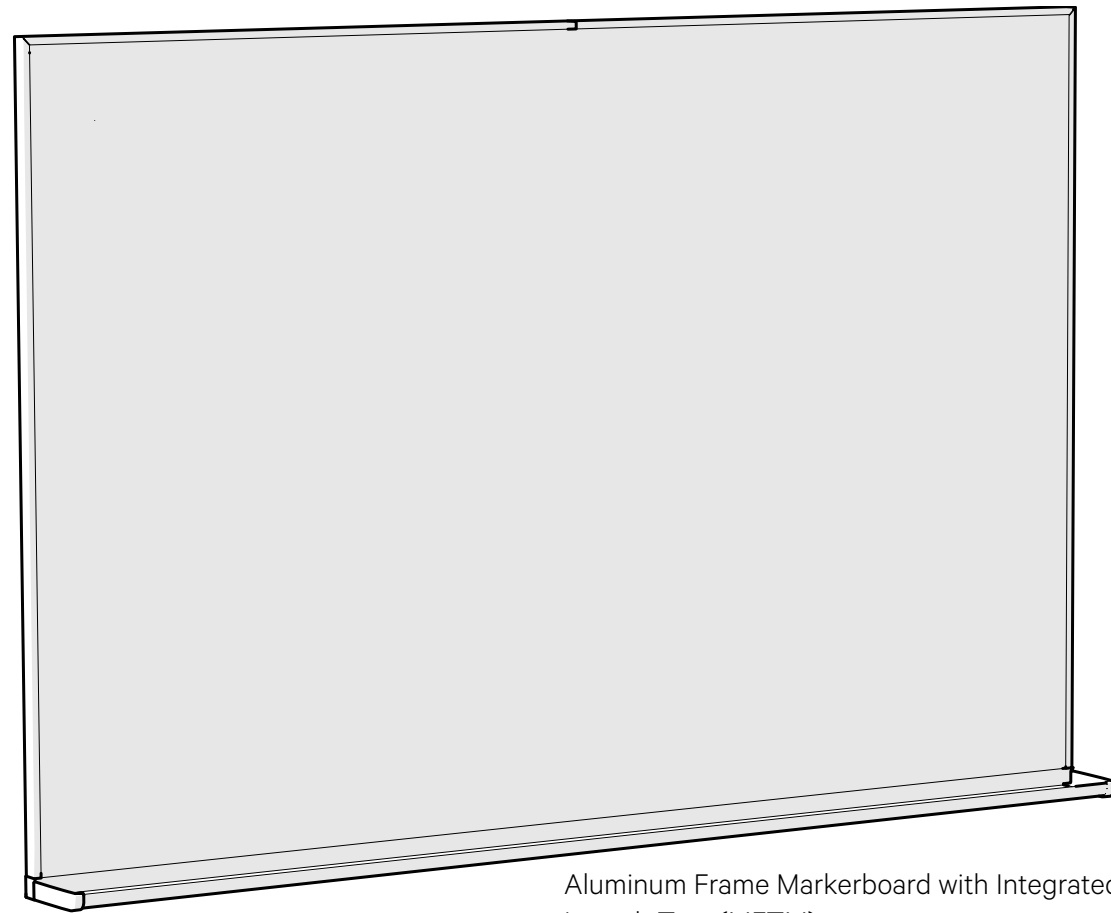

Aluminum Frame Markerboard with Integrated Full Length Tray (MFTM).

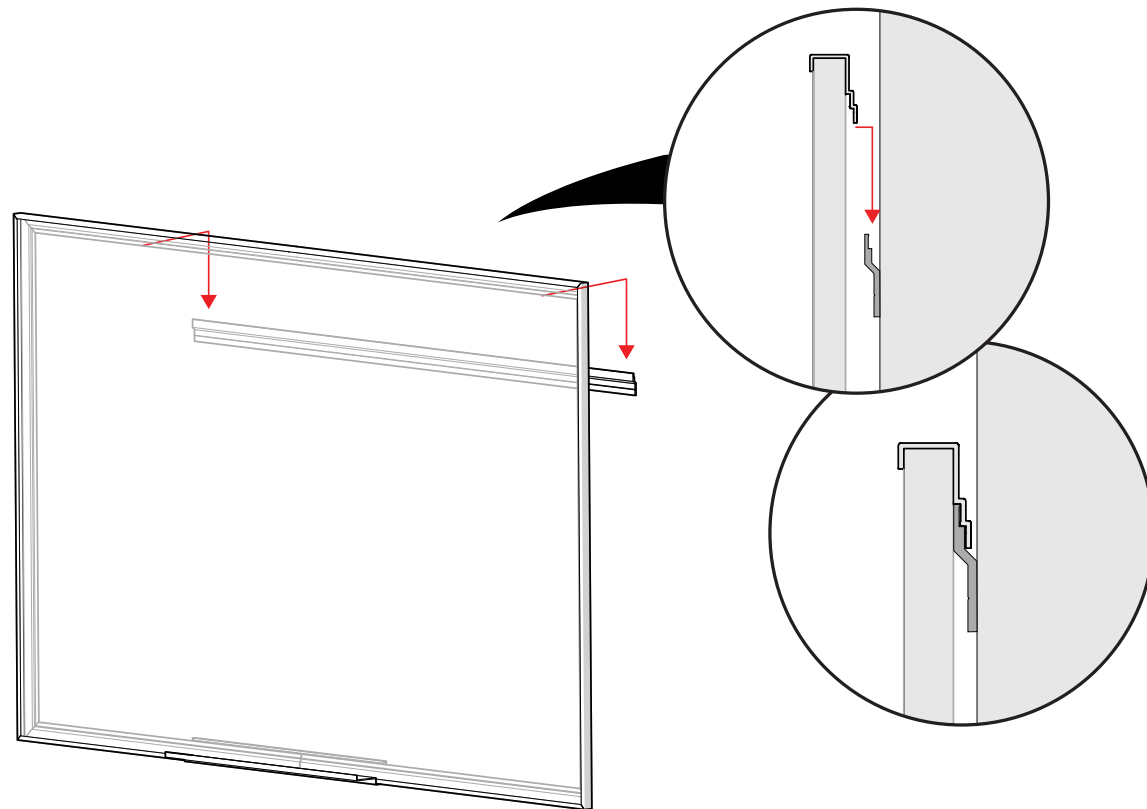

Wall mount brackets hang flush to the wall, and mounting hardware remains hidden in all Z-clip installs. The brackets are located at the top of the Aluminum Frame board, and slide into place using an interlocking hanging mechanism.

## ENVIRONMENTAL INFO

- [Mindful Materials](#)
- PW Precautionary List
- Red List Complaint
- meets LEEDv4
- Pre-Consumer
- Post-Consumer
- [GreenGuard Gold Certificates](#)

## WARRANTY INFORMATION

All Egan Visual products carry a warranty term of five (5) years from the date of purchase unless otherwise stated here:

- EVS® Presentation Surfaces "Guaranteed-to-Clean:" 10 years
- Porcelain surfaces: 10 years
- EganINK (ASTM F793 10a Category I Wallcovering): 1 year





## **BUILT TO INSPIRE**

We facilitate creativity, promote the sharing and capturing of ideas while seamlessly and beautifully complementing the existing workspace. We inspire the minds today, that will inspire the future. We are the blank canvas that gives life to the beginning of an idea

We offer a wide range of well-designed, productivity enhancing products that can be configured and sourced as either self-standing or integrated for a systematic solution that enhance and complement the people, the assets within the work space and provide a blank canvas for ideas to spark.