

# Markerboards & Tackboards

EganSystem 202 track-mounted markerboards and tackboards feature unique, adjustable corner mounts that slide on and off. This design permits boards to reconfigure easily - hang them in any orientation. Finished in EganMetallic to match the 202 Collection. Available with EVS™ or EganBoard Porcelain surfaces.

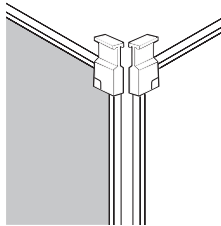
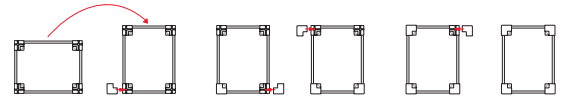

	EVS / EVS	EVS / Fabric	EVS / Grade A	EVS / Cork	Porcelain / Porcelain	Porcelain / Fabric	Porcelain / Grade A	Porcelain / Cork
26" w x 48" h	\$550	\$585	\$685	\$685	-	-	-	-
36" w x 48" h	\$690	\$765	\$875	\$875	\$790	\$815	\$980	\$980
60" w x 48" h*	\$1 070	-	-	-	-	-	-	-
26" w x 54" h	\$560	\$620	\$720	\$720	-	-	-	-
36" w x 54" h	\$720	\$890	\$890	\$890	-	-	-	-

Table indicates price for 2 sides. Eg. Side 1: EVS / Side 2: Fabric.  
 \*60x48 is not 2 sided and only specified with one side - EVS or Porcelain  
 Custom sizes available - Select next larger size and add \$150 to list / item  
 Custom Fabric Upcharge: \$150 List handling fee. Customer required to purchase fabric - COM (customer's own material).  
 Price Per side | EVS and Porcelain can not be specified in a combination together | Porcelain surface is not EganINK compatible  
 EVS and Porcelain are magnet compatible

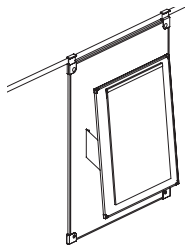

Flipchart Dimensions	EVS	Porcelain
Permanently mounted to a 36" w x 48" h	\$1 430	\$1 460

Track mounting flipchart holds a 27" w x 34" h flipchart pad. One (1) flipchart pad included

## 1. PRODUCT CODE

Code	Description
EETB	Markerboard EVS
EMTB	Markerboard Porcelain
EETBFC	Flipchart EVS
EMTBFC	Flipchart Porcelain

## 2. SURFACES

Code	Description
EE	Side 1: EVS / Side 2: EVS
EF	Side 1: EVS / Side 2: Fabric or Cork

For a full list of Standard and Grade A fabric options, visit [egan.com/fabrics-and-textiles/](http://egan.com/fabrics-and-textiles/)

## FINISHES

Code	Description
EM	EganMetallic
PY	Putty
CL	Charcoal

Custom Color upcharge: \$150/ product

## EGANINK

Specify EganINK on EVS for a minimum upcharge of \$200 or \$25/ sqft

## HOW TO ORDER

**EMTB 36 48 EF I**

1. Product Code      Width      Height      2. Surface      EganINK File supplied by Egan

## WHAT'S IN THE BOX

Two (2) assorted color Dry-Erase Markers  
 One (1) EganCloth