

**EGAN** EGANAERO





# EGANAERO

## WORLD'S THINNEST GLASS MARKERBOARDS

The worlds' thinnest, lightest, glass markerboard. EganAero features ultra thin high performance glass when installed on the wall. Its pristine appearance is supported by a scratch resistant and guaranteed-to-clean surface. EganAero uses the same high technology glass used in smartphones for a professional grade quality. These sleek, ultra-thin glass boards feature a durable, easy-to-clean surface. Boards are also neo- magnet compatibility, have high optical clarity, and clear legibility. Unlike other glass markerboards that suffer from poor legibility due to depth of field issues, writing on an EganAero board appears crisp, markings are shadowless, and the surface will come clean.

Available in over a 1000 standard colors using Egan's color palette as well as Custom Color using your color code or other industry standard fan deck, such as Pantone, you can discover the color right for your space. In addition to color, you can print your EganAero with high-resolution imagery using Egan's industry leading print service: EganINK. With endless custom options, EganAero boards offer tremendous design possibilities to enhance your space – and redefine how you collaborate.

Key Features:

- Low profile
- Scratch-resistant
- Neo-Magnet compatible
- Clean and sharp edges
- Smooth, easy writing
- Crisp, legible results with no drop shadows
- Over 1000 Standard Colors and Unlimited Custom Color Options
- EganINK compatible







**EGANAERO HOVER**

EganAero Hover provides unprecedented performance and sets a beautiful, thin design precedent. EganAer Hover is installed with a double-cleat Z-bracket, which gives its unique off-the wall hover appearance, and sits 5/16” (7.3mm) from the wall. A frameless design, the ultra-thin glassboard has a 1/8” radius corner.



EGANAERO EGANINK

Create even more powerful and functional pieces by adding EganINK to your EganAero board. EganINK is a high-resolution printing service that enhances your Egan products with interesting visual and communication tools. Match decor, incorporate logos, print high-resolution photography, graphics, or organizational charts and KPI templates. With EganINK, the possibilities are endless.







**EGANAERO BACKERS**

EganAero comes with a collection of distinct, modern backer options to suit the style and tone of your space. Select natural, warm wood backers to weave elements of nature into the workplace making for calming spaces, or choose modern textile designs for a clean, complete environment.



**EGANAERO BOXCORE**

EganAero is available in a Boxcore configuration - the glass Ultra Thin Hi-Performance glass enclosed in a 3/4" (19mm) deep frame. The EganAero glass has an ultra-thin bezel that sits flush on the wall. The Boxcore frame design is finished in clear anodized aluminum, and comes in square sharp edges and corners. EganAero comes with all its unique options: solid color, EganINK, veneers or brushed aluminum.







**EGANAERO  
ARCHITRAVE**

EganAero can also be an infill option under the Architrave design family. Architrave products are distinguished by a sturdy, 1 1/8" (29mm) oak wood frame that is finished with a thin bezel edge of 1/4" (6mm). The EganAero infill again comes with all its unique options, and the Architrave frame is finished between 4 oak stains options: Light Oak, Medium Oak, Dark Oak, and Black Oak.



# EGANAERO BOARDS



## GLASS OPTIONS



\*Specify any Pantone color for your Egan Aero board.

## SIZE OPTIONS

	48 x 36
	48 x 48
	48 x 60
	48 x 72

\* Custom sizes available upon request

## MOUNTING OPTIONS

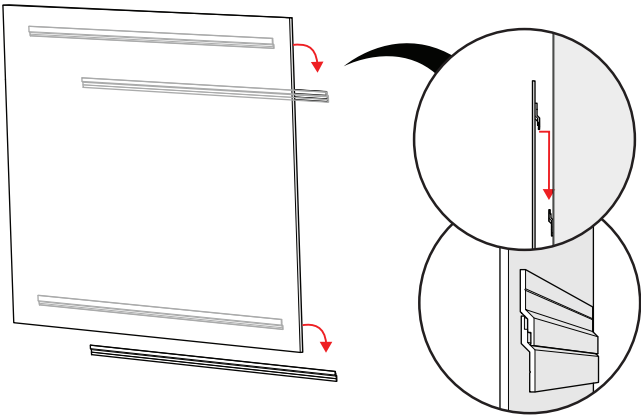

Cleat Mounted  
\*only available for color and magnetic





We facilitate creativity, promote the sharing and capturing of ideas while seamlessly and beautifully complementing the existing workspace. We inspire the minds today, that will inspire the future. We are the blank canvas that gives life to the beginning of an idea.

We offer a wide range of well-designed, productivity enhancing products that can be configured and sourced as either self-standing or integrated for a systematic solution that enhance and complement the people, the assets within the work space and provide a blank canvas for ideas to spark.