

Markerboard with Integrated Full Length Marker Tray

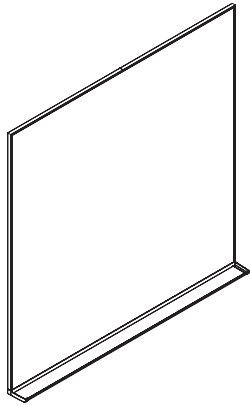

	EVS	Porcelain
24"w x 36"h	\$ 390	\$ 460
48"w x 36"h	\$ 595	\$ 650
48"w x 48"h	\$ 710	\$ 780
60"w x 48"h	\$ 840	\$ 920
72"w x 48"h	\$ 980	\$1050
96"w x 48"h	\$1160	\$1260
120"w x 48"h	\$1495	

Custom sizes available - Select next larger size and add \$150 to list per item

Presentation Boards

1. PRODUCT CODE

Code	Description
MFTE	EVS Square Frame
MFTM	Porcelain Square Frame

2. MOUNT

Code	Description
W	Wall Mount
T	Top Bracket
S	System Mount



Wall Mount Bracket: W



Top Bracket: T

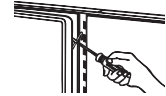

System Mount: S

Top Mount brackets are universal and can be easily adjusted to accommodate any workstation panel measuring from 1 3/4" to 2 3/4" thick. Adjustable by 1/8" increments. Due to weight restraints 72"w x 48"h, 85" x 53", 96"w x 48"h and 120" x 48" boards are not available with Top Bracket or System Mount. Brackets are aluminum with a clear anodized finish. Custom colors are not available on the brackets. Plastic protective sleeves are included to assure no damage is caused to the system. For panels 2 3/4"-4" deep please specify EOEX at \$12.

3. EGANINK

Specify EganINK on EVS for a minimum upcharge of \$200 or \$25/ sqft
Not available on Porcelain

HOW TO ORDER

MFTE 60 48 W I _____

1. Product Code Width Height 2. Mount Option 3. EganINK File # (supplied by Egan)

WHAT'S IN THE BOX

Mounting brackets as specified
Four (4) assorted color Dry-Erase Markers
One (1) EganCloth